

For Office Use Only

Application # W-26-20
Date Received 9/10/20
Fee Paid 215-
Zoning District RR
Parcel Tax Map ID# 06-0318.00
Flood Zone N River Corridor N Wetlands N

Requires further review: Site Plan Yes
Requires Planning Commission Review _____
Requires ZBA Approval _____
Date of above review(s) Oct. 6, 2020
Result of above review(s) _____

Approved if signed by appropriate Authority: _____

Permit Valid /// Permit Expires ///

Approved by Planning Commission 07/13/17

TOWN OF WHITINGHAM, VERMONT
PO Box 529, Jacksonsville, VT 05342
(802) 368-7500

APPLICATION FOR ZONING PERMIT

Location of Property (Street 911#) 268 N. Ryder Pond Rd
Name of Landowner Merlin W. Bartsels III email address mfbartsels@comcast.net
Mailing Address P.O. Box 26 Wilmington zip code 05363
Telephone Numbers - DAY 970 485 0275 EVENING same
Name of Applicant/Representative Merlin W. Bartsels III email address same
Telephone Numbers of Applicant/Representative - DAY 970 485 0275

APPLICATION IS MADE TO:

Build Alter Repair Extend Remove/Demolish Change of Use New Sign
Single-Family Dwelling Multi-Family Dwelling Commercial/Business Industrial
Accessory Structure Right-of-Way Home Occupation Home Industry Other

>>Any dwelling or additional living space greater than 500 square feet requires state energy code certification - REQUEST HANDBOOK

Description of Proposed Use and/or Structure: Home Industry

Parcel Description:

Parcel Size/Acreage: 2.0 acres Parcel Road Frontage: _____

EXISTING SETBACKS:

Front (from centerline of road) 40'
Right Side: 40' + 20'
Left Side: 20'
Rear: 40'
Height of Structure: 2 Story

PROPOSED SETBACKS:

Front (from centerline of road) N/A
Right Side: _____
Left Side: no change
Rear: _____
Height of Structure: _____

Dimensions of all Existing Buildings

(i.e. 38'x26'=988 sq.ft.)

Home: 4,000 Sq Ft
Garage: 23' x 26.5' = 609.5 Sq Ft
Accessory Bldg: N/A
Other: N/A

Dimensions of PROPOSED Buildings

Home: N/A
Garage: _____
Accessory Bldg: no change
Other: _____

NEW SQUARE FOOTAGE ON THIS APPLICATION _____

Application # W-26-20

Name Martin W. Bartels III

TOWN OF WHITTINGHAM, VT
PO Box 529, Jacksonsville, VT 05342
(802) 368-7500

APPLICATION FOR ZONING PERMIT

PERMISSION TO ENTER THE PROPERTY: Signing of this application authorizes the Zoning Administrator, Planning Commission, Zoning Board of Adjustment and/or Listers to enter onto the premises for the purpose of verifying the information presented.

The undersigned hereby affirms that all information presented in this application and all supporting forms, plans and documents is true, accurate, and complete and agree that, if any such information is found to be false or misleading, any permit or other approval granted on the basis of such information shall be deemed null and void. **Undersigned also affirms that he/she has contacted the State regarding needed permits.**

Martin W. Bartels III

Property Owner Signature

Date

Applicant Signature

Date

PLOT PLAN / SITE PLAN

This plan must show: Arrow pointing north ___ Street Name(s) ___ Property Lines & Dimensions ___ Existing and Proposed Structures with dimensions ___ Parking Areas ___ Driveway(s) ___ Setback Distances including from each side of property ___ Rear ___ Left Side ___ Right Side ___ Front Setback Distance from Center Line of Traveled Road (distances greater than 100 feet may be indicated as 100'+) on the plan) ___ Streams, Rivers, Bodies of Water ___ Water Supply ___ Sewage Treatment Area

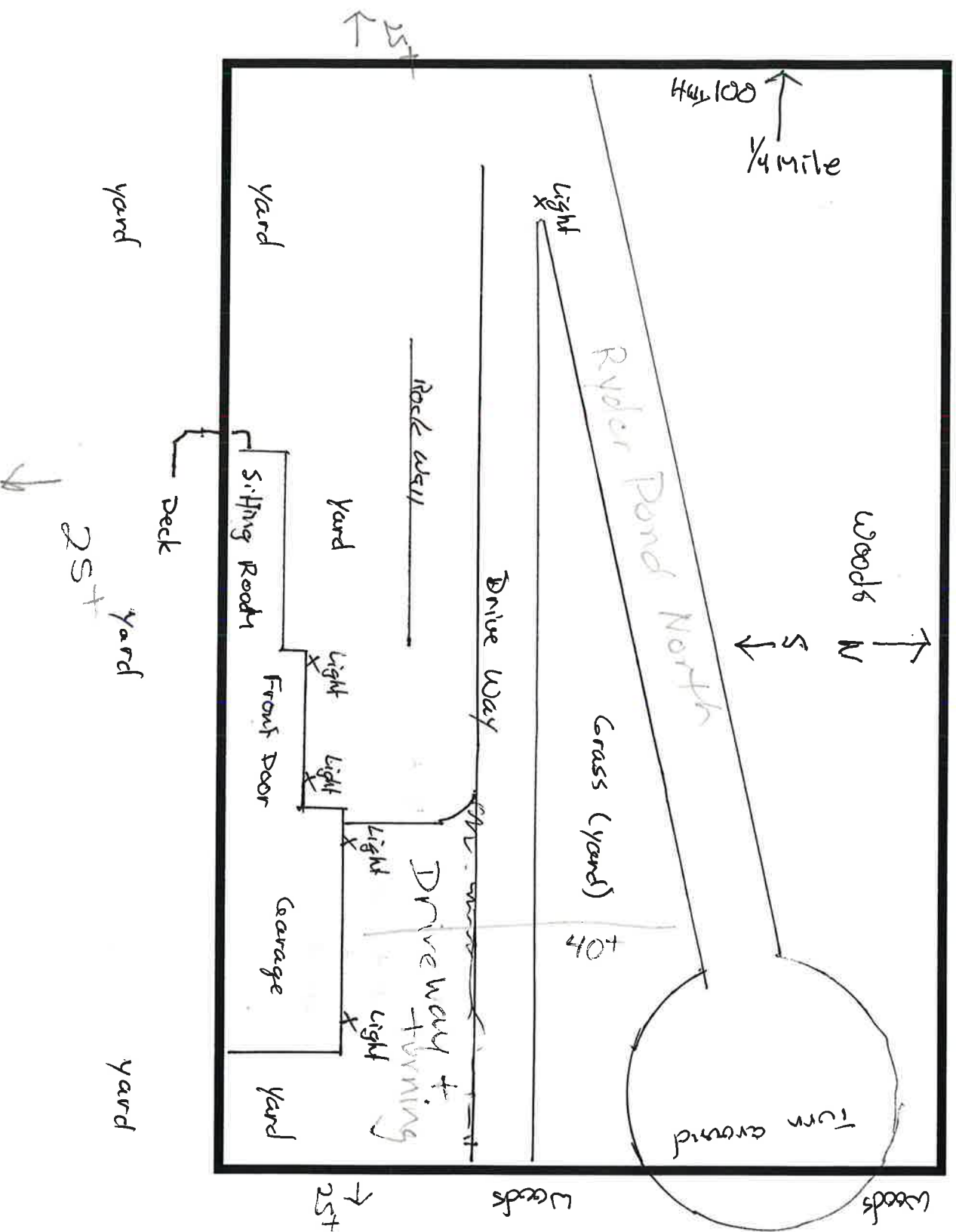

Ryder Pond